



For Sublease

±7,700 SF dead storage warehouse available

- Asking Rate: \$0.70/SF IG
- Sublease Expiration: March 31, 2024
- Loading: 1 dock high, 1 grade level
- Clear Height: 22'-26'
- Zoned: Light industrial
- Immediate access to I-880 and Oakland International Airport

2265 Polvorosa Ave
San Leandro, CA 94577
Suite 310

Eddie Shuai
+1 510 285 5368
eddie.shuai@am.jll.com
License #: 01454419

jll.com/eastbay-oakland/en-us



DISCLAIMER

Copyright © 2017 Jones Lang LaSalle IP, Inc. All rights reserved. All information contained herein is from sources deemed reliable; however, no representation or warranty is made to the accuracy thereof.

For Sublease

2265 Polvorosa Ave, San Leandro, CA 94577

Suite 310

±7,700 SF dead storage warehouse available

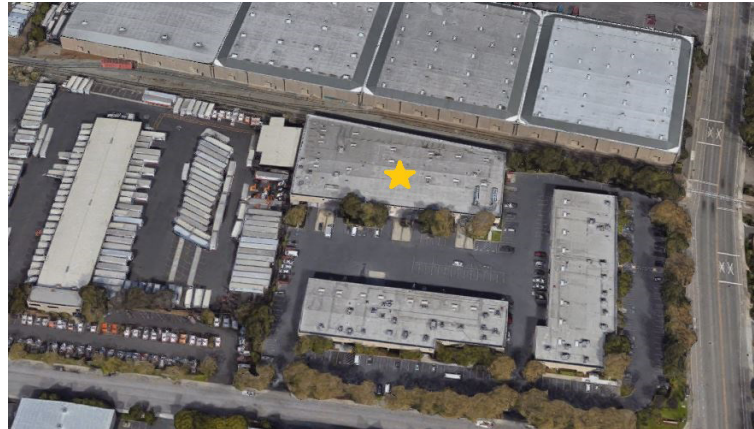
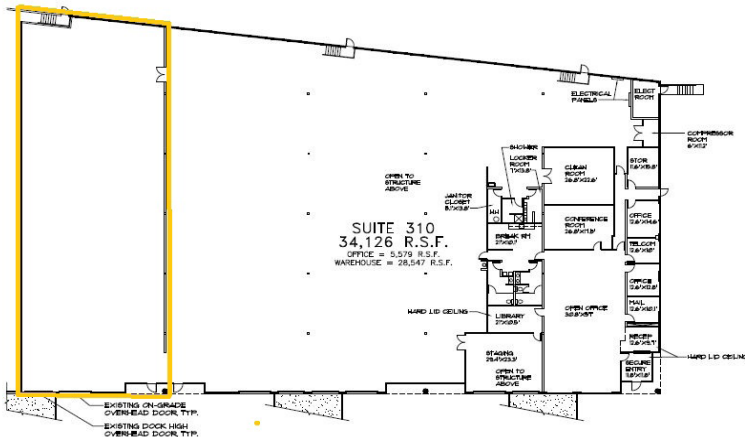

FOR LEASING INFORMATION:

Eddie Shuai

+1 510 285 5368

eddie.shuai@am.jll.com

License #: 01454419

