



For Lease

103,760 sq.ft. of warehouse space available now

- Basement space with excellent access through 2 truck level doors, 1 freight elevator, and with a possibility to add a drive in ramp.
- Excellent location less 10km from Dorval airport and 9km from downtown Montreal.
- Ideal for vehicle parking and other secure storage uses.
- Possibility to sub-divide.
- Asking price \$4.00 sq. ft. gross, including utilities.
- Accessible by public transport via STL bus lines 109, 195 and 350 with service to Angrignon metro station

INDUSTRIAL SERVICES GROUP

**2698 Léger, LaSalle,
QC H8N 1A3**

Brandon Allen

Vice president

Certified Real Estate Broker

+1 514 667 5644

brandon.allen@am.jll.com



Peter Mouhteros

Senior Associate,

Certified Real Estate Broker

+1 514 667 5675

peter.mouhteros@am.jll.com



Dimitri (Jimmy) Mouhteros

Associate

Commercial Real Estate Broker

+1 514 667 5691

dimitri.mouhteros@am.jll.com



Floor Plan

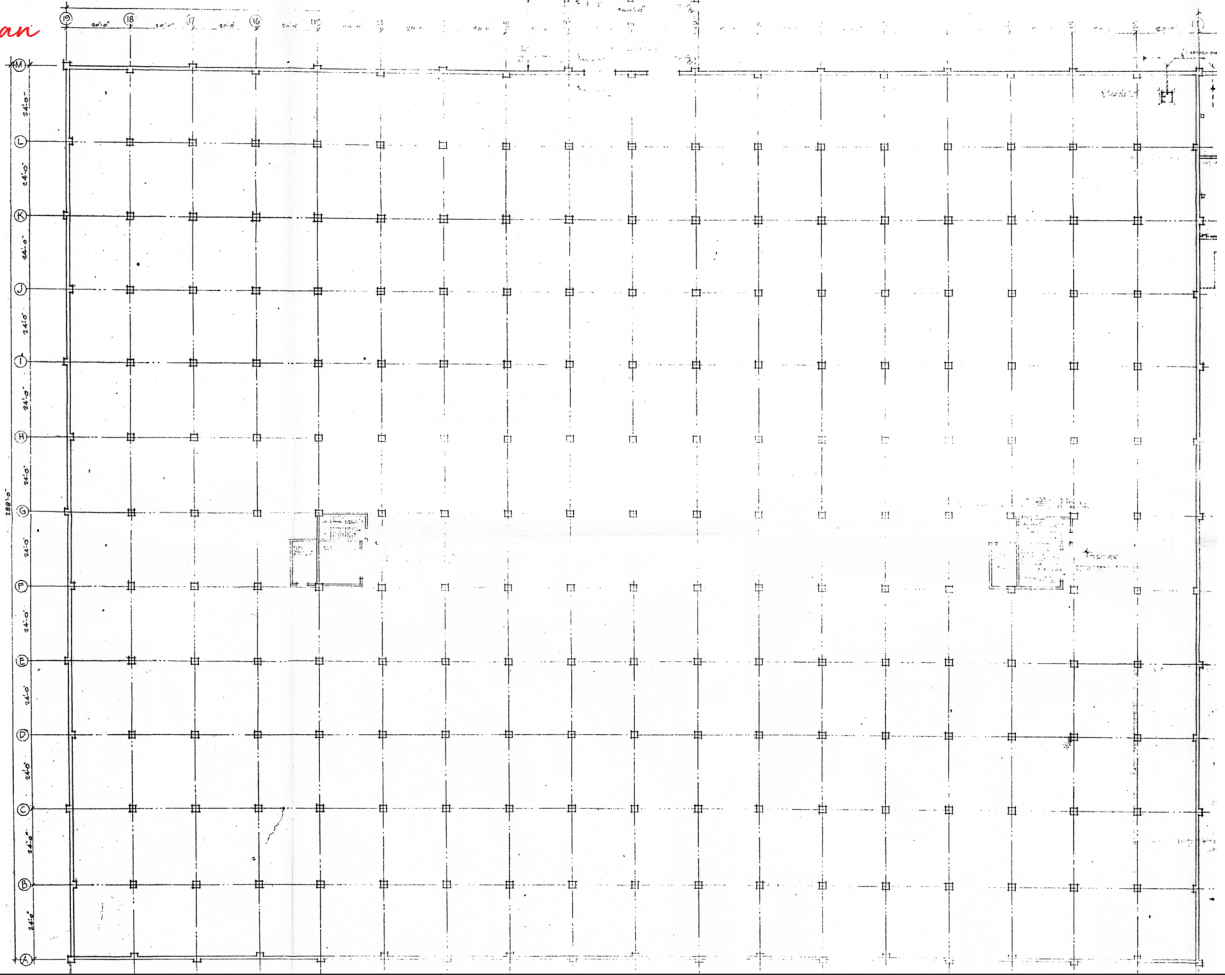

Property details

- Total Available area: 103,680 sq. ft.
- Minimum Divisible Space: 50,000 sq. ft.
- Clear height: 12'
- Construction year: 1965
- Truck level doors: 2
- Column Span: 24'x20'

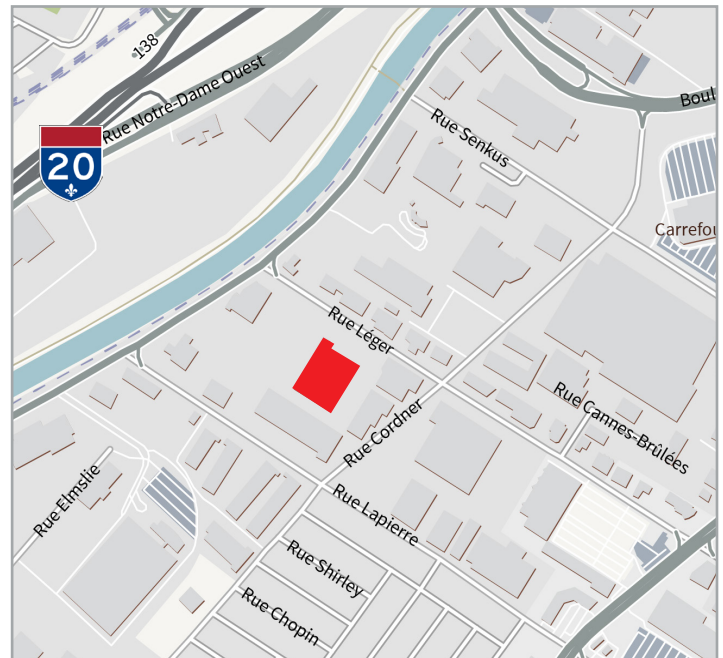

DISCLAIMER

© 2018 Jones Lang LaSalle Inc.

All rights reserved. All information contained herein is from sources deemed reliable; however, no representation or warranty is made as to the accuracy thereof. JLL Real Estate Services, Inc. Real Estate Agency.

